

SEM Specimen Stubs

Short Pin Type

Aluminium

1/2" Ø (12.7mm) with 3.2mm Ø x 8mm long pin, with groove for **Cambridge/LEO, Philips, Etec** etc instruments.

S081	1/2" Pin type stub (with groove)	pack of 100
S081/N	As above with alpha/numeric numbering	min pack of 100
S081/1	1/2" Pin type stub (with groove)	pack of 1000
S081/HP	1/2" Pin type stub (with groove) high purity Al for analysis apps	pack of 100
S081/T	1/2" Pin type stub	pack of 100
S182	1/2" Pin type stub (without groove)	pack of 100

S433	1/2" Pin type stub (with groove) Pin 3.2mm Ø x 6mm long for LEO	pack of 100
S434	1/2" Pin type stub (no groove) Pin 3.2mm Ø x 6mm long for LEO	pack of 100



S081/N
Please state sequence when ordering

Brass

S178	1/2" Pin type stub (with groove)	pack of 10
-------------	----------------------------------	------------

Copper

S179	1/2" Pin type stub (with groove)	pack of 10
-------------	----------------------------------	------------

1" Ø (25.4mm) Aluminium Short Pin type stub with 3.2mm Ø pin for **Cambridge/LEO** and **Philips** instruments.

S087	1" Pin type stub	pack of 50
-------------	------------------	------------

32mm Ø Aluminium Short Pin type stub with 3.2mm Ø pin for **Camscan**

S181	32mm Ø pin type stub	pack of 50
-------------	----------------------	------------

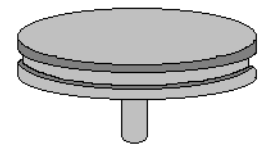

S087

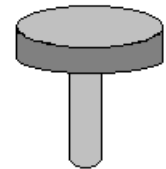

S180



S091

Long Pin Type

Aluminium 1/2" Ø (12.7mm) with 3.2mm Ø pin for **Amray**

S180	1/2" Amray pin stub	pack of 50
-------------	---------------------	------------

Re-entry Type

32mm (1 1/4") Ø re-entry (dish) type stub for **Cambridge/LEO**

S091	32mm (1 1/4") Ø Aluminium re-entry type stub	pack of 50
-------------	--	------------

Cylinder Type

Plain cylindrical aluminium stubs for **JEOL** instruments

S183	10mm Ø x 3.5mm high	pck of 50	S084	15mm Ø x 5mm high	pck of 50
S082	10mm Ø x 5mm high	pck of 50	S085	15mm Ø x 10mm high	pck of 50
S083	10mm Ø x 10mm high	pck of 50	S086	15mm Ø x 15mm high	pck of 50
S184	10mm Ø x 12.5mm high	pck of 50	S089	32mm Ø x 5mm high	pck of 50
S185	12.7mm Ø x 5mm high	pck of 50	S090	32mm Ø x 10mm high	pck of 50
S186	12.7mm Ø x 10mm high	pck of 50	S188	32mm Ø x 20mm high	pck of 50
S187	12.7mm Ø x 15mm high	pck of 50	S189	50mm Ø x 10mm high	pck of 50

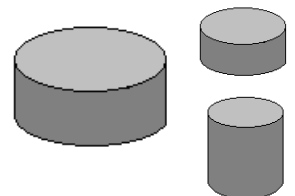

S261

Re-entry Type Stub Adapter

A simple, effective adapter to convert 12.7mm (1/2") pin stubs to allow 32mm (1.5") Ø re-entry dish type stubs to be used on 1/8" stage. The ball catch gives a trouble free, quick solution to a difficult problem.

S261	SEM stub adapter - re-entry stub
-------------	----------------------------------

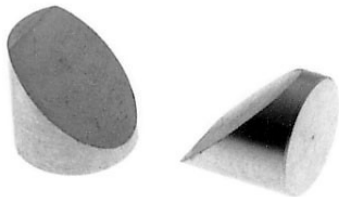

Chamfered Type

Aluminium stubs with a chamfered angle of 45° suitable for **JEOL** or **ISI** instruments where fitting stages are not available.

S127	Angled stub 10mm Ø	pack of 10
S190	Angled stub 12.7mm Ø	pack of 10
S126	Angled stub 15mm Ø	pack of 10

Threaded Type

Aluminium stubs threaded with M4 female thread in base for **Hitachi** instruments.

S128	Threaded stub 15mm Ø x 6mm high	pack of 50
S191	Threaded stub 25mm Ø x 6mm high	pack of 50
S192	Threaded stub 32mm Ø x 2mm high	pack of 50
S193	Threaded stub 32mm Ø x 10mm high	pack of 50

Carbon Stubs

Where the background radiation from the specimen stub is troublesome, a specimen stub manufactured from spectroscopic carbon may be used. Stubs for **Cambridge/LEO**, **JEOL** and **ISI** microscopes are available. They can have a *standard* finish or an *ultra smooth* finish for small particles or fibres.

S100	Carbon stub for Cambridge/LEO standard finish	each
S101	Carbon stub for Cambridge/LEO <i>ultra smooth</i> finish	each
S102	Carbon stub for JEOL (10mm Ø x 10mm H) standard	each
S103	Carbon stub for JEOL (10mm Ø x 10mm H) <i>ultra smooth</i>	each
S104	Carbon stub for ISI (15mm Ø x 10mm H) standard	each
S105	Carbon stub for ISI (15mm Ø x 10mm H) <i>ultra smooth</i>	each
S106	Carbon stub for Cambridge microanalysis stage std	each
S107	Carbon stub for Cambridge m/analysis stage <i>u/smooth</i>	each

Carbon Disc on Stub

This is an economical solution to the need for a light element surface for mounting specimens that are to be used for microanalysis. The carbon disc is 3mm thick and is glued to a standard ½" (12.7mm) stub.

Supplied in batches of 8 stubs in a stub storage box.

S111 Box of 8 carbon covered ½" (12.7mm) stubs

Slotted Specimen Stubs

S402 A 12.5mm slotted aluminium pin stub with two Allen screws allowing the specimen to be securely clamped for examination. Allen key supplied.

S403 A gripping pin stub with slot and single screw to allow specimens to be mounted edge-on for examination (designed at the University of Leicester).

Stub Adapters

These adapters allow JEOL, ISI/ABT and Hitachi users to accommodate the standard pin stubs of the European and American manufacturers. The conversion cylinder contains a clip to hold the pin stub.

S367	Converter for JEOL, 10mm Ø cylinder
S367/1	Converter for JEOL, 12.5mm Ø cylinder
S367/2	Converter for ISI/ABT, 15mm Ø cylinder
S367/3	Converter for Hitachi, 15mm Ø cylinder with M4 internal thread

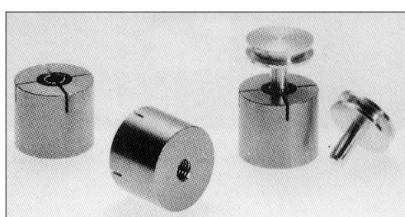
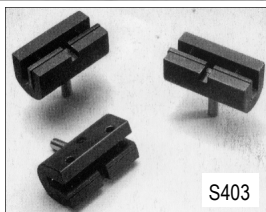
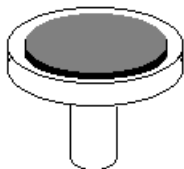
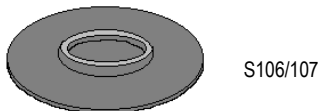
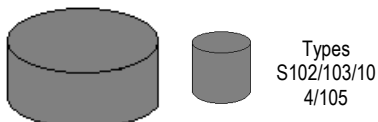
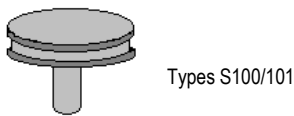
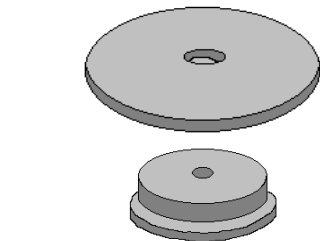

Specialised SEM Specimen Stubs

Stub for TEM Grids

In some applications (e.g. some SEM/EDX) results are improved if particulate samples are mounted on thin films deposited onto TEM grids. This pin-type aluminium stub allows four grids to be held securely for SEM work. There is a hole under each grid to reduce the backscatter component in electron collection and prevent extraneous X-ray collection.

- S400 SEM stub aluminium (pin-type) for TEM grids
- S401 SEM stub copper (pin-type) for TEM grids for cryo applications



Pin Stubs with Engraved Divisions

Aluminium SEM pin mounts with **engraved and numbered** divisions for multiple smaller samples to fit [FEI/Philips](#), [ZEISS/LEO](#), [Cambridge](#), [Leica](#), [Amray](#), [Tescan](#) and [Camscan](#) SEMs. Pin is 3.2mm (1/8") and 9mm (3/8") long. Quality machined smooth surface.

- | | | |
|--------|--------------------------------------|------------|
| S536 | 12.7mm Ø pin mount with 4 divisions | each |
| S536/1 | 12.7mm Ø pin mount with 4 divisions | pack of 10 |
| S537 | 19mm Ø pin mount with 4 divisions | each |
| S537/1 | 19mm Ø pin mount with 4 divisions | pack of 10 |
| S538 | 25.4mm Ø pin mount with 12 divisions | each |
| S538/1 | 25.4mm Ø pin mount with 12 divisions | pack of 10 |
| S539 | 32mm Ø pin mount with 12 divisions | each |
| S539/1 | 32mm Ø pin mount with 12 divisions | pack of 10 |

Pin Stubs

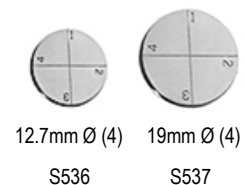

Special Size Aluminium Pin Stubs

- | | | |
|--------|---|-------------|
| S540 | SEM pin stub 6.4mm Ø diameter, standard pin | pack of 50 |
| S540/1 | SEM pin stub 6.4mm Ø diameter, standard pin | pack of 100 |
| S541 | SEM pin stub 12.7mm Ø with Flat on side | pack of 10 |
| S541/1 | SEM pin stub 12.7mm Ø with Flat on side | pack of 50 |
| S541/2 | SEM pin stub 12.7mm Ø with Flat on side | pack of 100 |
| S542 | SEM pin stub 38mm Ø with standard pin | each |
| S542/1 | SEM pin stub 38mm Ø with standard pin | pack of 10 |
| S543 | SEM pin stub 50mm Ø with standard pin | each |
| S543/1 | SEM pin stub 50mm Ø with standard pin | pack of 10 |
| S544 | SEM pin stub 63mm Ø with standard pin | each |
| S544/1 | SEM pin stub 63mm Ø with standard pin | pack of 10 |
| S545 | SEM pin stub 100mm Ø with standard pin | each |
| S545/1 | SEM pin stub 100mm Ø with standard pin | pack of 10 |



Angled Pin Stubs

- | | | |
|--------|--|------------|
| S546 | EM-Tec PS15 Pin stub swivel mount , 15mm Ø, 15mm pin | each |
| S547 | 45° angled <i>high</i> profile Al SEM pin stub 12.7mm Ø standard pin | pack of 5 |
| S548 | 45/90° angled <i>high</i> profile SEM pin stub 12.7mm Ø standard pin | each |
| S548/1 | 45/90° angled <i>high</i> profile SEM pin stub 12.7mm Ø standard pin | pack of 5 |
| S548/2 | 45/90° angled <i>high</i> profile SEM pin stub 12.7mm Ø standard pin | pack of 10 |
| S549 | 45° angled <i>standard</i> profile SEM pin stub 12.7mm Ø std pin | each |
| S549/1 | 45° angled <i>standard</i> profile SEM pin stub 12.7mm Ø std pin | pack of 5 |
| S549/2 | 45° angled <i>standard</i> profile SEM pin stub 12.7mm Ø std pin | pack of 10 |
| S550 | 45° angled <i>standard</i> profile SEM pin stub 25.4mm mm Ø std pin | each |
| S550/1 | 45° angled <i>standard</i> profile SEM pin stub 25.4mm Ø std pin | pack of 5 |
| S550/2 | 45° angled <i>standard</i> profile SEM pin stub 25.4mm Ø std pin | pack of 10 |
| S551 | 45/90° angled <i>standard</i> profile SEM pin stub 25.4mm Ø std pin | each |
| S551/1 | 45/90° angled <i>standard</i> profile SEM pin stub 25.4mm Ø std pin | pack of 5 |
| S551/2 | 45/90° angled <i>standard</i> profile SEM pin stub 25.4mm Ø std pin | pack of 10 |



Angled Pin Stubs cont..



S552	Double 45/90° angled SEM pin stub 25.4mm Ø standard Al pin	each
S552/1	Double 45/90° angled SEM pin stub 25.4mm Ø standard Al pin	pack of 5
S553	Double 90° SEM pin stub 25.4mm Ø standard pin Al pin	each
S553/1	Double 90° SEM pin stub 25.4mm Ø standard pin Al pin	pack of 5
S554	45/90° SEM pin stub 32mm Ø standard pin Al	each
S554/1	45/90° SEM pin stub 32mm Ø standard pin Al	pack of 5
S555	Double 90° SEM pin stub 32mm Ø standard pin Al pin	each
S555/1	Double 90° SEM pin stub 32mm Ø standard pin Al pin	pack of 5

SEM Pin Stubs with Extra Height



S556	Pin stub extender 12.7mm Ø x 22.7mm (10mm extra height)	each
S557	Pin stub 12.7mm Ø 4mm extra height std pin Al	pack of 5
S557/1	Pin stub 12.7mm Ø 4mm extra height std pin Al	pack of 10
S557/2	Pin stub 12.7mm Ø 4mm extra height std pin Al	pack of 50
S558	Pin stub 12.7mm Ø 6mm extra height std pin Al	pack of 5
S558/1	Pin stub 12.7mm Ø 6mm extra height std pin Al	pack of 10
S558/2	Pin stub 12.7mm Ø 6mm extra height std pin Al	pack of 50
S559	Pin stub 25.4mm Ø 4mm extra height std pin Al	pack of 5
S559/1	Pin stub 25.4mm Ø 4mm extra height std pin Al	pack of 10
S559/2	Pin stub 25.4mm Ø 4mm extra height std pin Al	pack of 50

SEM Pin Stubs Low Profile



S560	Low profile SEM pin stub 12.7mm Ø with 1mm height, Al	pack of 5
S560/1	Low profile SEM pin stub 12.7mm Ø with 1mm height, Al	pack of 10
S560/2	Low profile SEM pin stub 12.7mm Ø with 1mm height, Al	pack of 50
S561	Low profile pin stub 12.7mm Ø with 35° for Tescan, FIB x SEM	pack of 5
S561/1	Low profile pin stub 12.7mm Ø with 35° for Tescan, FIB x SEM	pack of 10
S561/2	Low profile pin stub 12.7mm Ø with 35° for Tescan, FIB x SEM	pack of 50
S562	Low profile pin stub 12.7mm Ø with 38° for Tescan, FIB x SEM	pack of 5
S562/1	Low profile pin stub 12.7mm Ø with 38° for Tescan, FIB x SEM	pack of 10
S562/2	Low profile pin stub 12.7mm Ø with 38° for Tescan, FIB x SEM	pack of 50

Dish top Pin Stub

S563	SEM Dish pin stub, 12.7mm Ø x 7mm with 1.5mm dish depth Al	each
S563/1	SEM Dish pin stub, 12.7mm Ø x 7mm with 1.5mm dish depth Al	pack of 5
S563/2	SEM Dish pin stub, 12.7mm Ø x 7mm with 1.5mm dish depth Al	pack of 10

Specialised JEOL SEM Stubs



S564	JEOL 9.5mm Ø x 9.5mm angled SEM stub with 45° and 90° Al	pack of 10
S564/1	JEOL 9.5mm Ø x 9.5mm angled SEM stub with 45° and 90° Al	pack of 50
S565	JEOL 12.2mm Ø x 10mm angled SEM stub with 45° and 90° Al	pack of 10
S565/1	JEOL 12.2mm Ø x 10mm angled SEM stub with 45° and 90° Al	pack of 50
S566	JEOL 25mm Ø x 16mm angled SEM sample stub with 45° Al	pack of 5
S566/1	JEOL 25mm Ø x 16mm angled SEM sample stub with 45° Al	pack of 10
S567	JEOL 25mm Ø x 16mm SEM sample stub with 45° & 90° angles Al	each
S567/1	JEOL 25mm Ø x 16mm SEM sample stub with 45° & 90° angles Al	pack of 5
S568	JEOL 25mm Ø x 16mm SEM sample stub with double 90° Al	each
S568/1	JEOL 25mm Ø x 16mm SEM sample stub with double 90° Al	pack of 5
S569	JEOL Dish stub, 12.2mm Ø x 10mm with 1.5mm dish depth Al	pack of 10
S569/1	JEOL Dish stub, 12.2mm Ø x 10mm with 1.5mm dish depth Al	pack of 50

Specialised Hitachi SEM Stubs

S570	Hitachi 15mm Ø x 10mm M4 angled SEM sample stub 45° Al	each
S570/1	Hitachi 15mm Ø x 10mm M4 angled SEM sample stub 45° Al	pack of 10
S571	Hitachi 25mm Ø x 16mm M4 angled SEM sample stub 45° Al	each
S571/1	Hitachi 25mm Ø x 16mm M4 angled SEM sample stub 45° Al	pack of 10
S572	Hitachi 15mm Ø x 11mm M4 angled SEM sample stub 45° & 90° Al	each
S572/1	Hitachi 15mm Ø x 11mm M4 angled SEM sample stub 45° & 90° Al	pack of 10
S573	Hitachi 25mm Ø x 16mm M4 angled SEM sample stub 45° & 90° Al	each
S573/1	Hitachi 25mm Ø x 16mm M4 angled SEM sample stub 45° & 90° Al	pack of 10
S574	Hitachi 25mm Ø x 16mm M4 angled SEM stub, double 90° Al	each
S574/1	Hitachi 25mm Ø x 16mm M4 angled SEM stub, double 90° Al	pack of 10
S575	Hitachi 32mm Ø x 12mm M4 angled SEM sample stub 45° & 90° Al	each
S575/1	Hitachi 32mm Ø x 12mm M4 angled SEM sample stub 45° & 90° Al	pack of 10
S576	Hitachi 15mm Ø x 10mm M4 dish SEM sample stub, Al	pack of 5
S576/1	Hitachi 15mm Ø x 10mm M4 dish SEM sample stub, Al	pack of 10
S576/2	Hitachi 15mm Ø x 10mm M4 dish SEM sample stub, Al	pack of 50

