

## SEM Specimen Stubs

### Short Pin Type

#### Aluminium

1/2" Ø (12.7mm) with 3.2mm Ø x 8mm long pin, with groove for **Cambridge/LEO, Philips, Etec** etc instruments.

<b>S081</b>	1/2" Pin type stub (with groove)	pack of 100
<b>S081/N</b>	As above with alpha/numeric numbering	min pack of 100
<b>S081/1</b>	1/2" Pin type stub (with groove)	pack of 1000
<b>S081/HP</b>	1/2" Pin type stub (with groove) high purity Al for analysis apps	pack of 100
<b>S081/T</b>	1/2" Pin type stub	pack of 100
<b>S182</b>	1/2" Pin type stub (without groove)	pack of 100

<b>S433</b>	1/2" Pin type stub (with groove) Pin 3.2mm Ø x 6mm long for LEO	pack of 100
<b>S434</b>	1/2" Pin type stub (no groove) Pin 3.2mm Ø x 6mm long for LEO	pack of 100



S081/N  
Please state sequence when ordering

#### Brass

<b>S178</b>	1/2" Pin type stub (with groove)	pack of 10
-------------	----------------------------------	------------

#### Copper

<b>S179</b>	1/2" Pin type stub (with groove)	pack of 10
-------------	----------------------------------	------------

**1" Ø (25.4mm)** Aluminium Short Pin type stub with 3.2mm Ø pin for **Cambridge/LEO** and **Philips** instruments.

<b>S087</b>	1" Pin type stub	pack of 50
-------------	------------------	------------

**32mm Ø** Aluminium Short Pin type stub with 3.2mm Ø pin for **Camscan**

<b>S181</b>	32mm Ø pin type stub	pack of 50
-------------	----------------------	------------

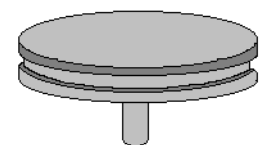

S087

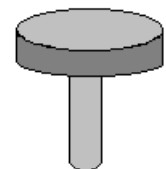

S180



S091

### Long Pin Type

Aluminium 1/2" Ø (12.7mm) with 3.2mm Ø pin for **Amray**

<b>S180</b>	1/2" Amray pin stub	pack of 50
-------------	---------------------	------------

### Re-entry Type

32mm (1 1/4") Ø re-entry (dish) type stub for **Cambridge/LEO**

<b>S091</b>	32mm (1 1/4") Ø Aluminium re-entry type stub	pack of 50
-------------	--	------------

### Cylinder Type

Plain cylindrical aluminium stubs for **JEOL** instruments

<b>S183</b>	10mm Ø x 3.5mm high	pck of 50	<b>S084</b>	15mm Ø x 5mm high	pck of 50
<b>S082</b>	10mm Ø x 5mm high	pck of 50	<b>S085</b>	15mm Ø x 10mm high	pck of 50
<b>S083</b>	10mm Ø x 10mm high	pck of 50	<b>S086</b>	15mm Ø x 15mm high	pck of 50
<b>S184</b>	10mm Ø x 12.5mm high	pck of 50	<b>S089</b>	32mm Ø x 5mm high	pck of 50
<b>S185</b>	12.7mm Ø x 5mm high	pck of 50	<b>S090</b>	32mm Ø x 10mm high	pck of 50
<b>S186</b>	12.7mm Ø x 10mm high	pck of 50	<b>S188</b>	32mm Ø x 20mm high	pck of 50
<b>S187</b>	12.7mm Ø x 15mm high	pck of 50	<b>S189</b>	50mm Ø x 10mm high	pck of 50

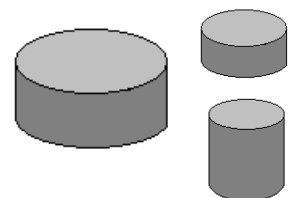

S261

### Re-entry Type Stub Adapter

A simple, effective adapter to convert 12.7mm (1/2") pin stubs to allow 32mm (1.5") Ø re-entry dish type stubs to be used on 1/8" stage. The ball catch gives a trouble free, quick solution to a difficult problem.

<b>S261</b>	SEM stub adapter - re-entry stub
-------------	----------------------------------

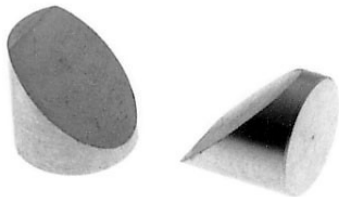

### Chamfered Type

Aluminium stubs with a chamfered angle of 45° suitable for **JEOL** or **ISI** instruments where fitting stages are not available.

<b>S127</b>	Angled stub 10mm Ø	pack of 10
<b>S190</b>	Angled stub 12.7mm Ø	pack of 10
<b>S126</b>	Angled stub 15mm Ø	pack of 10

### Threaded Type

Aluminium stubs threaded with M4 female thread in base for **Hitachi** instruments.

<b>S128</b>	Threaded stub 15mm Ø x 6mm high	pack of 50
<b>S191</b>	Threaded stub 25mm Ø x 6mm high	pack of 50
<b>S192</b>	Threaded stub 32mm Ø x 2mm high	pack of 50
<b>S193</b>	Threaded stub 32mm Ø x 10mm high	pack of 50

### Carbon Stubs

Where the background radiation from the specimen stub is troublesome, a specimen stub manufactured from spectroscopic carbon may be used. Stubs for **Cambridge/LEO**, **JEOL** and **ISI** microscopes are available. They can have a *standard* finish or an *ultra smooth* finish for small particles or fibres.

<b>S100</b>	Carbon stub for Cambridge/LEO standard finish	each
<b>S101</b>	Carbon stub for Cambridge/LEO <i>ultra smooth</i> finish	each
<b>S102</b>	Carbon stub for JEOL (10mm Ø x 10mm H) standard	each
<b>S103</b>	Carbon stub for JEOL (10mm Ø x 10mm H) <i>ultra smooth</i>	each
<b>S104</b>	Carbon stub for ISI (15mm Ø x 10mm H) standard	each
<b>S105</b>	Carbon stub for ISI (15mm Ø x 10mm H) <i>ultra smooth</i>	each
<b>S106</b>	Carbon stub for Cambridge microanalysis stage std	each
<b>S107</b>	Carbon stub for Cambridge m/analysis stage <i>u/smooth</i>	each

### Carbon Disc on Stub

This is an economical solution to the need for a light element surface for mounting specimens that are to be used for microanalysis. The carbon disc is 3mm thick and is glued to a standard ½" (12.7mm) stub.

Supplied in batches of 8 stubs in a stub storage box.

**S111** Box of 8 carbon covered ½" (12.7mm) stubs

### Slotted Specimen Stubs

**S402** A 12.5mm slotted aluminium pin stub with two Allen screws allowing the specimen to be securely clamped for examination. Allen key supplied.

**S403** A gripping pin stub with slot and single screw to allow specimens to be mounted edge-on for examination (designed at the University of Leicester).

### Stub Adapters

These adapters allow JEOL, ISI/ABT and Hitachi users to accommodate the standard pin stubs of the European and American manufacturers. The conversion cylinder contains a clip to hold the pin stub.

<b>S367</b>	Converter for JEOL, 10mm Ø cylinder
<b>S367/1</b>	Converter for JEOL, 12.5mm Ø cylinder
<b>S367/2</b>	Converter for ISI/ABT, 15mm Ø cylinder
<b>S367/3</b>	Converter for Hitachi, 15mm Ø cylinder with M4 internal thread

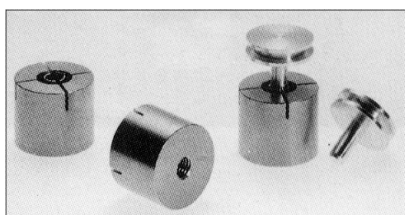
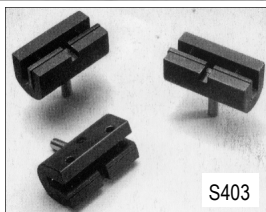
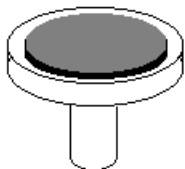
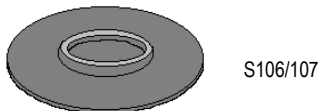
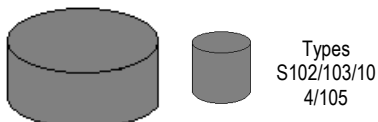
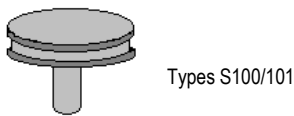
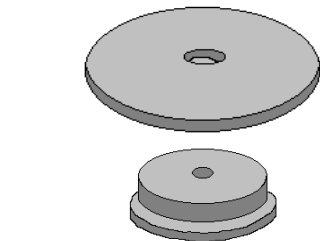

## Specialised SEM Specimen Stubs

### Stub for TEM Grids

In some applications (e.g. some SEM/EDX) results are improved if particulate samples are mounted on thin films deposited onto TEM grids. This pin-type aluminium stub allows four grids to be held securely for SEM work. There is a hole under each grid to reduce the backscatter component in electron collection and prevent extraneous X-ray collection.

- S400 SEM stub aluminium (pin-type) for TEM grids
- S401 SEM stub copper (pin-type) for TEM grids for cryo applications



### Pin Stubs with Engraved Divisions

Aluminium SEM pin mounts with **engraved and numbered** divisions for multiple smaller samples to fit [FEI/Philips](#), [ZEISS/LEO](#), [Cambridge](#), [Leica](#), [Amray](#), [Tescan](#) and [Camscan](#) SEMs. Pin is 3.2mm (1/8") and 9mm (3/8") long. Quality machined smooth surface.

- |        |                                      |            |
|--------|--------------------------------------|------------|
| S536   | 12.7mm Ø pin mount with 4 divisions  | each       |
| S536/1 | 12.7mm Ø pin mount with 4 divisions  | pack of 10 |
| S537   | 19mm Ø pin mount with 4 divisions    | each       |
| S537/1 | 19mm Ø pin mount with 4 divisions    | pack of 10 |
| S538   | 25.4mm Ø pin mount with 12 divisions | each       |
| S538/1 | 25.4mm Ø pin mount with 12 divisions | pack of 10 |
| S539   | 32mm Ø pin mount with 12 divisions   | each       |
| S539/1 | 32mm Ø pin mount with 12 divisions   | pack of 10 |

Pin Stubs

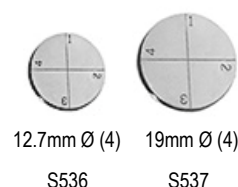

### Special Size Aluminium Pin Stubs

- |        |   |             |
|--------|---|-------------|
| S540   | SEM pin stub 6.4mm Ø diameter, standard pin | pack of 50  |
| S540/1 | SEM pin stub 6.4mm Ø diameter, standard pin | pack of 100 |
| S541   | SEM pin stub 12.7mm Ø with Flat on side     | pack of 10  |
| S541/1 | SEM pin stub 12.7mm Ø with Flat on side     | pack of 50  |
| S541/2 | SEM pin stub 12.7mm Ø with Flat on side     | pack of 100 |
| S542   | SEM pin stub 38mm Ø with standard pin       | each        |
| S542/1 | SEM pin stub 38mm Ø with standard pin       | pack of 10  |
| S543   | SEM pin stub 50mm Ø with standard pin       | each        |
| S543/1 | SEM pin stub 50mm Ø with standard pin       | pack of 10  |
| S544   | SEM pin stub 63mm Ø with standard pin       | each        |
| S544/1 | SEM pin stub 63mm Ø with standard pin       | pack of 10  |
| S545   | SEM pin stub 100mm Ø with standard pin      | each        |
| S545/1 | SEM pin stub 100mm Ø with standard pin      | pack of 10  |



### Angled Pin Stubs

- |        |  |            |
|--------|--|------------|
| S546   | EM-Tec PS15 Pin stub <b>swivel mount</b> , 15mm Ø, 15mm pin          | each       |
| S547   | 45° angled <i>high profile</i> Al SEM pin stub 12.7mm Ø standard pin | pack of 5  |
| S548   | 45/90° angled <i>high profile</i> SEM pin stub 12.7mm Ø standard pin | each       |
| S548/1 | 45/90° angled <i>high profile</i> SEM pin stub 12.7mm Ø standard pin | pack of 5  |
| S548/2 | 45/90° angled <i>high profile</i> SEM pin stub 12.7mm Ø standard pin | pack of 10 |
| S549   | 45° angled <i>standard profile</i> SEM pin stub 12.7mm Ø std pin     | each       |
| S549/1 | 45° angled <i>standard profile</i> SEM pin stub 12.7mm Ø std pin     | pack of 5  |
| S549/2 | 45° angled <i>standard profile</i> SEM pin stub 12.7mm Ø std pin     | pack of 10 |
| S550   | 45° angled <i>standard profile</i> SEM pin stub 25.4mm mm Ø std pin  | each       |
| S550/1 | 45° angled <i>standard profile</i> SEM pin stub 25.4mm Ø std pin     | pack of 5  |
| S550/2 | 45° angled <i>standard profile</i> SEM pin stub 25.4mm Ø std pin     | pack of 10 |
| S551   | 45/90° angled <i>standard profile</i> SEM pin stub 25.4mm Ø std pin  | each       |
| S551/1 | 45/90° angled <i>standard profile</i> SEM pin stub 25.4mm Ø std pin  | pack of 5  |
| S551/2 | 45/90° angled <i>standard profile</i> SEM pin stub 25.4mm Ø std pin  | pack of 10 |



## Angled Pin Stubs cont..



<b>S552</b>	Double 45/90° angled SEM pin stub 25.4mm Ø standard Al pin	each
<b>S552/1</b>	Double 45/90° angled SEM pin stub 25.4mm Ø standard Al pin	pack of 5
<b>S553</b>	Double 90° SEM pin stub 25.4mm Ø standard pin Al pin	each
<b>S553/1</b>	Double 90° SEM pin stub 25.4mm Ø standard pin Al pin	pack of 5
<b>S554</b>	45/90° SEM pin stub 32mm Ø standard pin Al	each
<b>S554/1</b>	45/90° SEM pin stub 32mm Ø standard pin Al	pack of 5
<b>S555</b>	Double 90° SEM pin stub 32mm Ø standard pin Al pin	each
<b>S555/1</b>	Double 90° SEM pin stub 32mm Ø standard pin Al pin	pack of 5

## SEM Pin Stubs with Extra Height



<b>S556</b>	Pin stub extender 12.7mm Ø x 22.7mm (10mm extra height)	each
<b>S557</b>	Pin stub 12.7mm Ø 4mm extra height std pin Al	pack of 5
<b>S557/1</b>	Pin stub 12.7mm Ø 4mm extra height std pin Al	pack of 10
<b>S557/2</b>	Pin stub 12.7mm Ø 4mm extra height std pin Al	pack of 50
<b>S558</b>	Pin stub 12.7mm Ø 6mm extra height std pin Al	pack of 5
<b>S558/1</b>	Pin stub 12.7mm Ø 6mm extra height std pin Al	pack of 10
<b>S558/2</b>	Pin stub 12.7mm Ø 6mm extra height std pin Al	pack of 50
<b>S559</b>	Pin stub 25.4mm Ø 4mm extra height std pin Al	pack of 5
<b>S559/1</b>	Pin stub 25.4mm Ø 4mm extra height std pin Al	pack of 10
<b>S559/2</b>	Pin stub 25.4mm Ø 4mm extra height std pin Al	pack of 50

## SEM Pin Stubs Low Profile



<b>S560</b>	Low profile SEM pin stub 12.7mm Ø with 1mm height, Al	pack of 5
<b>S560/1</b>	Low profile SEM pin stub 12.7mm Ø with 1mm height, Al	pack of 10
<b>S560/2</b>	Low profile SEM pin stub 12.7mm Ø with 1mm height, Al	pack of 50
<b>S561</b>	Low profile pin stub 12.7mm Ø with 35° for Tescan, FIB x SEM	pack of 5
<b>S561/1</b>	Low profile pin stub 12.7mm Ø with 35° for Tescan, FIB x SEM	pack of 10
<b>S561/2</b>	Low profile pin stub 12.7mm Ø with 35° for Tescan, FIB x SEM	pack of 50
<b>S562</b>	Low profile pin stub 12.7mm Ø with 90° Al	pack of 5
<b>S562/1</b>	Low profile pin stub 12.7mm Ø with 90° Al	pack of 10
<b>S562/2</b>	Low profile pin stub 12.7mm Ø with 90° Al	pack of 50

## Dish top Pin Stub

<b>S563</b>	SEM Dish pin stub, 12.7mm Ø x 7mm with 1.5mm dish depth Al	each
<b>S563/1</b>	SEM Dish pin stub, 12.7mm Ø x 7mm with 1.5mm dish depth Al	pack of 5
<b>S563/2</b>	SEM Dish pin stub, 12.7mm Ø x 7mm with 1.5mm dish depth Al	pack of 10

## Specialised JEOL SEM Stubs



<b>S564</b>	JEOL 9.5mm Ø x 9.5mm angled SEM stub with 45° and 90° Al	pack of 10
<b>S564/1</b>	JEOL 9.5mm Ø x 9.5mm angled SEM stub with 45° and 90° Al	pack of 50
<b>S565</b>	JEOL 12.2mm Ø x 10mm angled SEM stub with 45° and 90° Al	pack of 10
<b>S565/1</b>	JEOL 12.2mm Ø x 10mm angled SEM stub with 45° and 90° Al	pack of 50
<b>S566</b>	JEOL 25mm Ø x 16mm angled SEM sample stub with 45° Al	pack of 5
<b>S566/1</b>	JEOL 25mm Ø x 16mm angled SEM sample stub with 45° Al	pack of 10
<b>S567</b>	JEOL 25mm Ø x 16mm SEM sample stub with 45° & 90° angles Al	each
<b>S567/1</b>	JEOL 25mm Ø x 16mm SEM sample stub with 45° & 90° angles Al	pack of 5
<b>S568</b>	JEOL 25mm Ø x 16mm SEM sample stub with double 90° Al	each
<b>S568/1</b>	JEOL 25mm Ø x 16mm SEM sample stub with double 90° Al	pack of 5
<b>S569</b>	JEOL Dish stub, 12.2mm Ø x 10mm with 1.5mm dish depth Al	pack of 10
<b>S569/1</b>	JEOL Dish stub, 12.2mm Ø x 10mm with 1.5mm dish depth Al	pack of 50

## Specialised Hitachi SEM Stubs

<b>S570</b>	Hitachi 15mm Ø x 10mm M4 angled SEM sample stub 45° Al	each
<b>S570/1</b>	Hitachi 15mm Ø x 10mm M4 angled SEM sample stub 45° Al	pack of 10
<b>S571</b>	Hitachi 25mm Ø x 16mm M4 angled SEM sample stub 45° Al	each
<b>S571/1</b>	Hitachi 25mm Ø x 16mm M4 angled SEM sample stub 45° Al	pack of 10
<b>S572</b>	Hitachi 15mm Ø x 11mm M4 angled SEM sample stub 45° & 90° Al	each
<b>S572/1</b>	Hitachi 15mm Ø x 11mm M4 angled SEM sample stub 45° & 90° Al	pack of 10
<b>S573</b>	Hitachi 25mm Ø x 16mm M4 angled SEM sample stub 45° & 90° Al	each
<b>S573/1</b>	Hitachi 25mm Ø x 16mm M4 angled SEM sample stub 45° & 90° Al	pack of 10
<b>S574</b>	Hitachi 25mm Ø x 16mm M4 angled SEM stub, double 90° Al	each
<b>S574/1</b>	Hitachi 25mm Ø x 16mm M4 angled SEM stub, double 90° Al	pack of 10
<b>S575</b>	Hitachi 32mm Ø x 12mm M4 angled SEM sample stub 45° & 90° Al	each
<b>S575/1</b>	Hitachi 32mm Ø x 12mm M4 angled SEM sample stub 45° & 90° Al	pack of 10
<b>S576</b>	Hitachi 15mm Ø x 10mm M4 dish SEM sample stub, Al	pack of 5
<b>S576/1</b>	Hitachi 15mm Ø x 10mm M4 dish SEM sample stub, Al	pack of 10
<b>S576/2</b>	Hitachi 15mm Ø x 10mm M4 dish SEM sample stub, Al	pack of 50

