

## SEM Sample Stub Adapters

SEM stub adapters enable the use of all common types of SEM stubs or mounts in your SEM

## JEOL to Hitachi Stub Adapters



- S784** J10H JEOL 9.5mm Ø adapter for M4 Hitachi stubs 9.5 x 9.5mm Ø.  
**S785** J12H JEOL 12.2mm Ø adapter for M4 Hitachi stubs 12.2 Ø x 10mm  
**S786** J25H JEOL 25mm Ø adapter for M4 Hitachi stubs 25mm Ø x 10mm

## Hitachi to JEOL Stub Adapters



- S787** HJ10 Hitachi M4 adapter for JEOL stubs 9.5mm Ø.  
**S788** HJ11 Hitachi M4 adapter for JEOL stubs 12.2mm Ø  
**S789** HJ12 Hitachi M4 adapter for JEOL stubs 15mm Ø  
**S790** HJ25 Hitachi M4 adapter for JEOL stubs 25mm Ø  
**S791** HJ32 Hitachi M4 adapter for JEOL stubs 32mm Ø  
**S792** HJ50 Hitachi M4 adapter for JEOL stubs 50mm Ø

### Pin stub adapters for using different SEM stubs in pin type SEMs such as FEI, Philips, Tescan, Phenom, Aspex, Cambridge Instruments, Leica, etc.

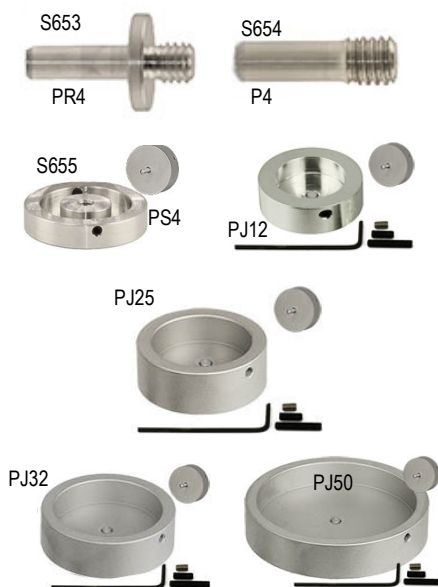

- S653** PR4 pin (3.2 x 9.5mm) stub adapter for Hitachi M4 with support rim for larger stubs/holders 9mm Ø x 15mm deep each  
**S654** P4 pin (3.2 x 9.5mm) stub adapter for Hitachi M4 straight for smaller stubs/holders 4mm Ø x 13.5mm deep each  
**S655** PS4 pin (3.2 x 9.5mm) stub adapter for Cambridge S4 mounts 30mm Ø x 19.5mm deep each  
**S656** PJ12 pin stub adapter for 12.2 and 9.5mm Ø JEOL stubs. Accepts up to 16mm Ø cylinder stubs. Can also be used for Hitachi 15mm Ø and 15mm Ø ISI/ABT/Topcon stubs. Has set screw to secure the SEM stubs. Overall size 25mm Ø x 19.5mm. Includes Allen key.  
**S657** PJ25 pin stub adapter for 25mm Ø JEOL & Hitachi stubs. This adapter accepts up to 25mm Ø cylinder stubs. Can also be used for the Hitachi 25mm Ø stubs or 25mm Ø/1inch metallographic mounts. Set screw is used to secure the stubs. Machined from vacuum grade aluminium. Overall size Ø34x19.5mm. Includes Allen key.  
**S658** PJ32 pin stub adapter for 32mm Ø JEOL & Hitachi stubs. This adapter accepts up to 32mm Ø cylinder stubs. Can also be used for the Hitachi 32mm Ø stubs or 30mm Ø/1.25 inch metallographic mounts. Set screw is used to secure the stubs. Machined from vacuum grade aluminium. Overall size Ø40 x 19.5mm. Includes Allen key.  
**S659** PJ50 pin stub adapter for 50mm Ø JEOL & Hitachi stubs. This adapter accepts up to 50mm Ø cylinder stubs. Can also be used for the Hitachi 50mm Ø stubs or 50mm Ø/2 inch metallographic mounts. Set screw is used to secure the stubs. Machined from vacuum grade aluminium. Overall size 59mm Ø x 19.5mm. Includes Allen key.

### Pin Stub Adapter for Incident Light Microscope Observation



**S797** M31P metal slide adapter to accommodate standard and short Zeiss pin stubs on upright reflected/incident light microscopes. Top part accepts the 3.2mm pin of the pin stubs. Designed for pin stubs up to 25.4mm diameter, but will work with pin stubs of 32 and 38mm as well. Pin stub can be secured with a stainless steel M3 screw. Overall size is 76.2 x 25.4 x 11.2mm. Made from black metal anodised aluminium slide with a 25mm aluminium pin stub adapter.

**Zeiss short pin stub adapters** for using different SEM stubs in Zeiss and LEO SEMs.  
**Pin stub adapters with the longer pin can be easily modified for use on Zeiss & LEO SEMs.**

**S647** ZR4 Zeiss pin stub adapter for **Hitachi M4** with support rim. Suitable for larger SEM stubs and larger SEM holders with M4 thread. Used on Zeiss and LEO SEMs. Pin is standard **3.2mm Ø and 6mm** long. The support rim has a 9mm Ø to give extra stability for larger SEM stubs and holders. Machined from vacuum grade aluminium. Overall size is 9mm Ø x1.5mm.



**S648** Z4 Zeiss pin stub adapter to **Hitachi M4** for smaller SEM stubs and SEM holders with M4 thread. Used on Zeiss and LEO SEMs. Pin is standard 3.2mm diameter and 6mm long. Small design where the head of the adapter fits in the M4 thread. Machined from vacuum grade aluminium. Overall size is 4mm Ø x10mm.

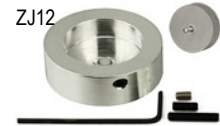

**S649** ZJ12 Zeiss pin stub adapter for 12.2mm and 9.5mm Ø **JEOL** stubs. This stub adapter accepts up to 16mm Ø cylinder stubs. Can also be used for the **Hitachi** and **ISI/ABT/Topcon** 15mm Ø stubs. Set screw is used to secure the stubs. Machined from vacuum grade aluminium. Overall size Ø25x16mm. Includes Allen key.



**S650** ZJ25 Zeiss pin stub adapter for 25mm Ø **JEOL** stubs. This stub adapter accepts up to 25mm Ø cylinder stubs. Can also be used for the **Hitachi** 25mm/1" Ø stubs or 25mm Ø/1" metallographic mounts. Set screw is used to secure the stubs. Machined from vacuum grade aluminium. Overall size Ø34x16mm. Includes Allen key.



**S651** ZJ32 Zeiss pin stub adapter for 32mm Ø **JEOL** stubs. This stub adapter accepts up to 32mm Ø cylinder stubs. Can also be used for the **Hitachi** 32mm/1" Ø stubs or 30mm Ø/1.25" metallographic mounts. Set screw is used to secure the stubs. Machined from vacuum grade aluminium. Overall size Ø34x16mm. Includes Allen key.



**S652** ZJ50 Zeiss pin stub adapter for 50mm Ø **JEOL** stubs. This stub adapter accepts up to 50mm Ø cylinder stubs. Can also be used for the 50 mm/2" Ø stubs or 30mm Ø/2" metallographic mounts. Set screw is used to secure the stubs. Machined from vacuum grade aluminium. Overall size Ø34x16mm. Includes Allen key

## Other Pin Stub Adapters

These adapters allow JEOL, ISI/ABT and Hitachi users to accommodate the standard pin stubs of the European and American manufacturers. The conversion cylinder contains a clip to hold the pin stub.

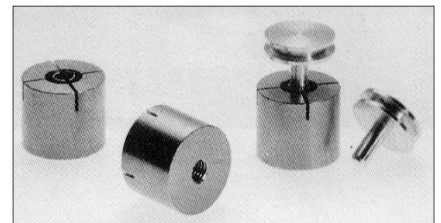

- S367** Converter for JEOL, 10mm Ø cylinder
- S367/1** Converter for JEOL, 12.5mm Ø cylinder
- S367/2** Converter for ISI/ABT, 15mm Ø cylinder
- S367/3** Converter for Hitachi, 15mm Ø cylinder with M4 internal thread

## Gatan 3View sample pin stubs, tweezers and storage box

- G311** Gatan 3View system SEM pin stubs with standard 1.4mm Ø flat, 2mm Ø pin x12.5mm H, aluminium pack of 10
- G311/1** Gatan 3View system SEM pin stubs with standard 1.4mm Ø flat, 2mm Ø pin x12.5mm H, aluminium pack of 50
- G213** Gatan 3View system SEM pin stubs with large 2.4mm Ø flat, 2mm Ø pin x12.5mm H, aluminium pack of 10
- G312/1** Gatan 3View system SEM pin stubs with large 2.4mm Ø flat, 2mm Ø pin x12.5mm H, aluminium pack of 50
- T612** Gatan 3View stub handling tweezers, 118mm, anti-magnetic S/S each



- B581** PS28 storage box for 28 Gatan 3View pin stubs each

